

## MODEL : BV-201 [ Two Piece Body Ball Valve Full Port ]

Connection : Flange JIS10K

Material : Cast Iron



### ◆ MAIN PARAMETER SPECIFICATION

1. Face to Face : JIS B2002
2. End Flange Dimensions : JIS B2212
3. Working Pressure : 10K
4. Pressure test : JIS B2003
5. Actuator Mounting Pad : ISO 5211\*

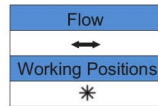

### ◆ MATERIAL LIST

No	Part Name	Material
1	Body	Cast Iron- FC200-A126
2	Ball	ASTMA351-CF8-SS304
3	*Seat	PTFE
4	Stem	SS13%Cr

### ◆ DIMENSIONS (mm)

DN	L	D	D1	A	Weight (kg)
40	165 ±1.5	140	105	210.5	8.28
50	180 ±1.5	155	120	210.5	10.47
65	190 ±1.5	175	140	235	14.23
80	200 ±2	185	150	235	17
100	230 ±2	210	175	317	25.76
125	300 ±2	250	210	629.5	41
150	340 ±2	280	240	629.5	57.4
200	450 ±2	330	290	1100	101.6

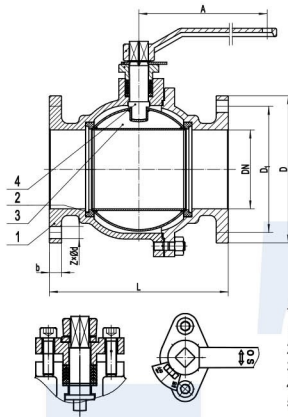

## MODEL : BV-201 [ Two Piece Body Ball Valve Full Port ]

Connection : Flange JIS10K

Material : WCB, CF8, CF8M



### ◆ MAIN PARAMETER SPECIFICATION

1. Face to Face : JIS B2002
2. End Flange Dimensions : JIS B2212
3. Working Pressure : 10K
4. Pressure test : JIS B2003
5. Actuator Mounting Pad : ISO 5211\*

### ◆ MATERIAL LIST

No	Part Name	Material		
1	Body	A216-WCB	CF8	CF8M
2	Ball	CF8	CF8	CF8M
3	*Seat	PTFE	PTFE 15% Glassfield	PTFE 15% Glassfield
4	Stem	SS13%Cr	SS304	SS316

### ◆ DIMENSIONS (mm)

Size	DN	L	D	D1	D2	Weight (Kg)
1/2"	15	108	95	70	52	1.95
3/4"	20	117	100	75	58	2.45
1"	25	127	125	90	70	3.9
1" - 1/4"	32	140	135	100	80	4.9
1" - 1/2"	40	165	140	105	85	6.15
2"	50	178	155	120	100	7.5
2" - 1/2"	65	190	175	140	120	10.8
3"	80	203	185	150	130	13.6
4"	100	229	210	175	155	18.6
5"	125	356	250	210	185	35
6"	150	394	280	240	215	42.6
8"	200	457	330	290	265	72
10"	250	533	400	355	325	-

